

Ing. GIAN ANTONIO MAZZOCCHIN

ufficio: via BRENTILLA, 54 35013 CITTADELLA (PD)

tel. 049/5970666 338/3569966

c.f. MZZ GNT 60A21 C743D

Tav.

9B

PROGETTO : Piano di Lottizzazione "OLIVARI GREEN"

OGGETTO : Elaborati grafici con dati metrici/quantità
per la stesura del computo metrico

COMUNE: Galliera Veneta (PD)

DITTA : *Costruzioni Martini S.r.l.*
Birollo S.n.c. di Marchiori Elda & Figli

SCALE

DATA DICEMBRE 2018

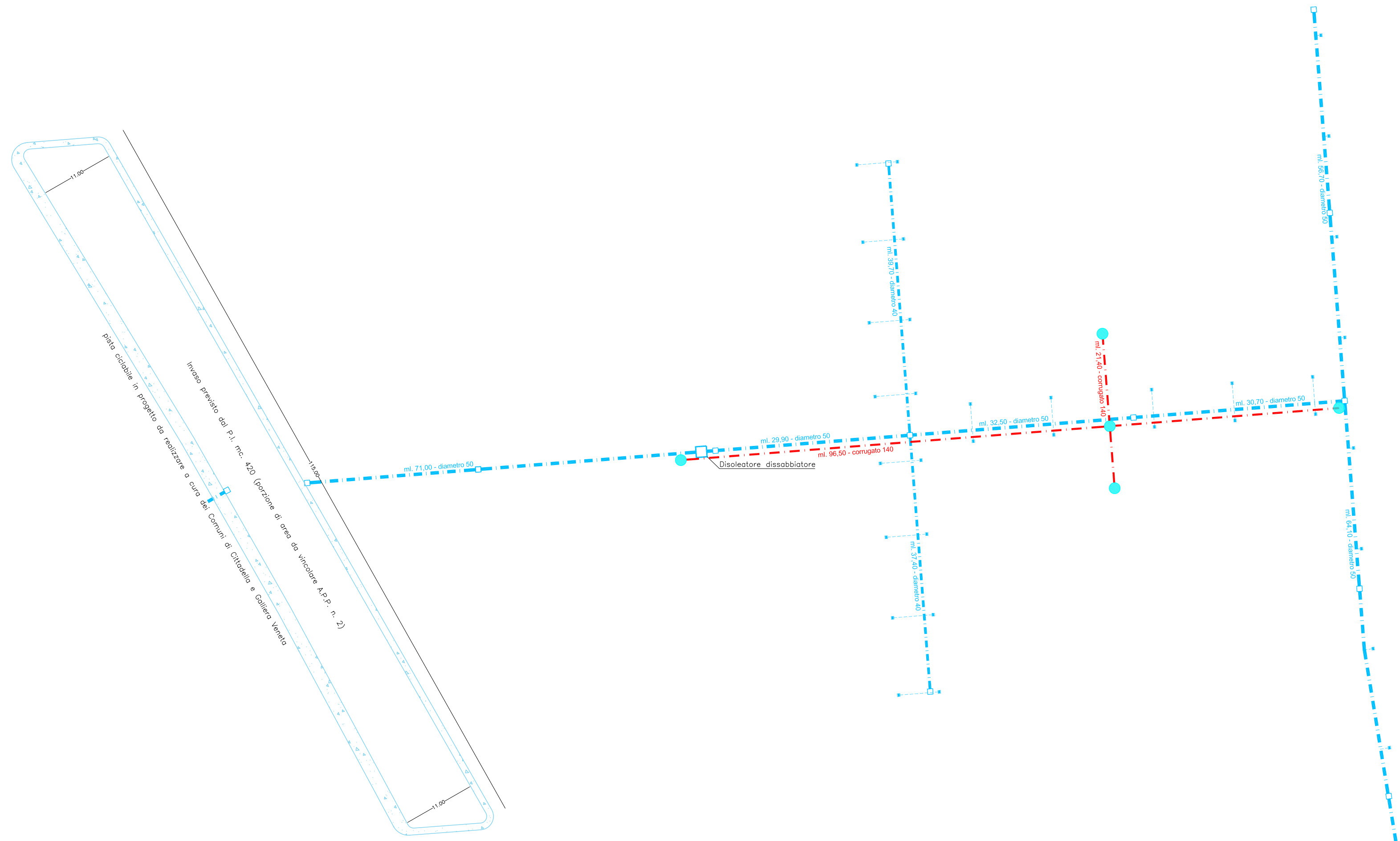

FOGNATURA ACQUE BIANCHE
 PREDISPOSIZIONE IMPIANTO IRRIGAZIONE

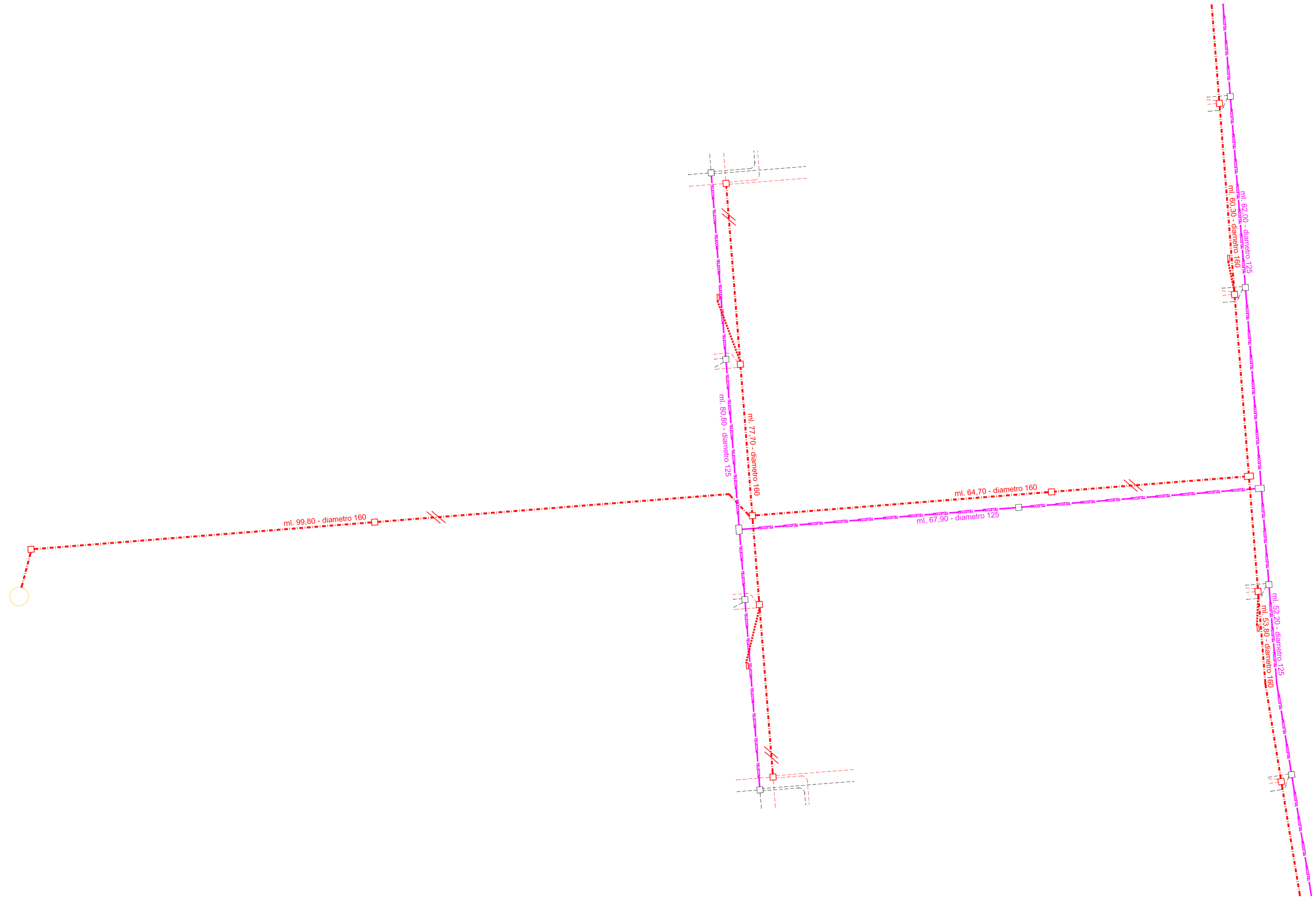

RETE ENEL e TELEFONO

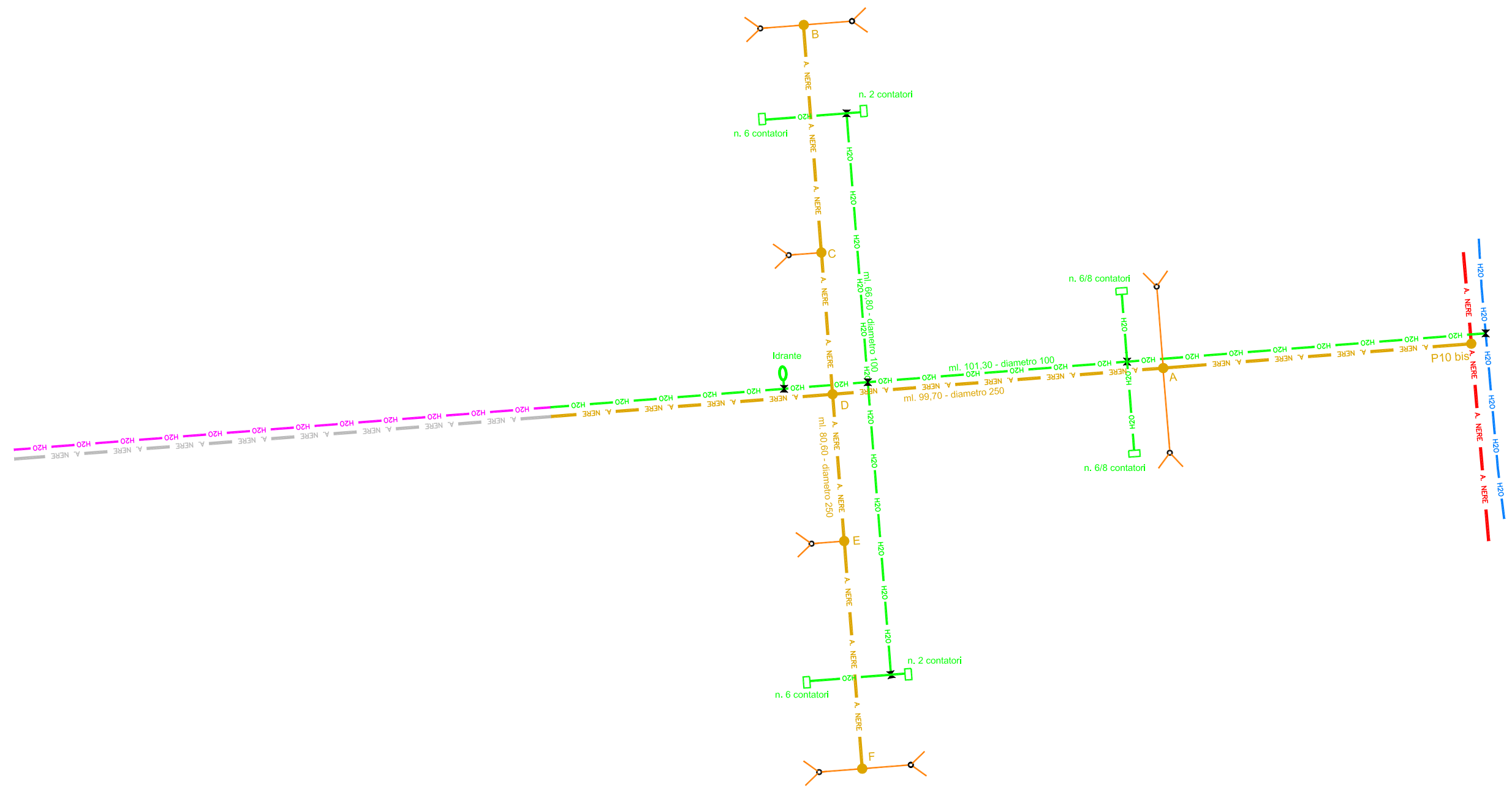

RETE ACQUEDOTTO E FOGNATURA NERA

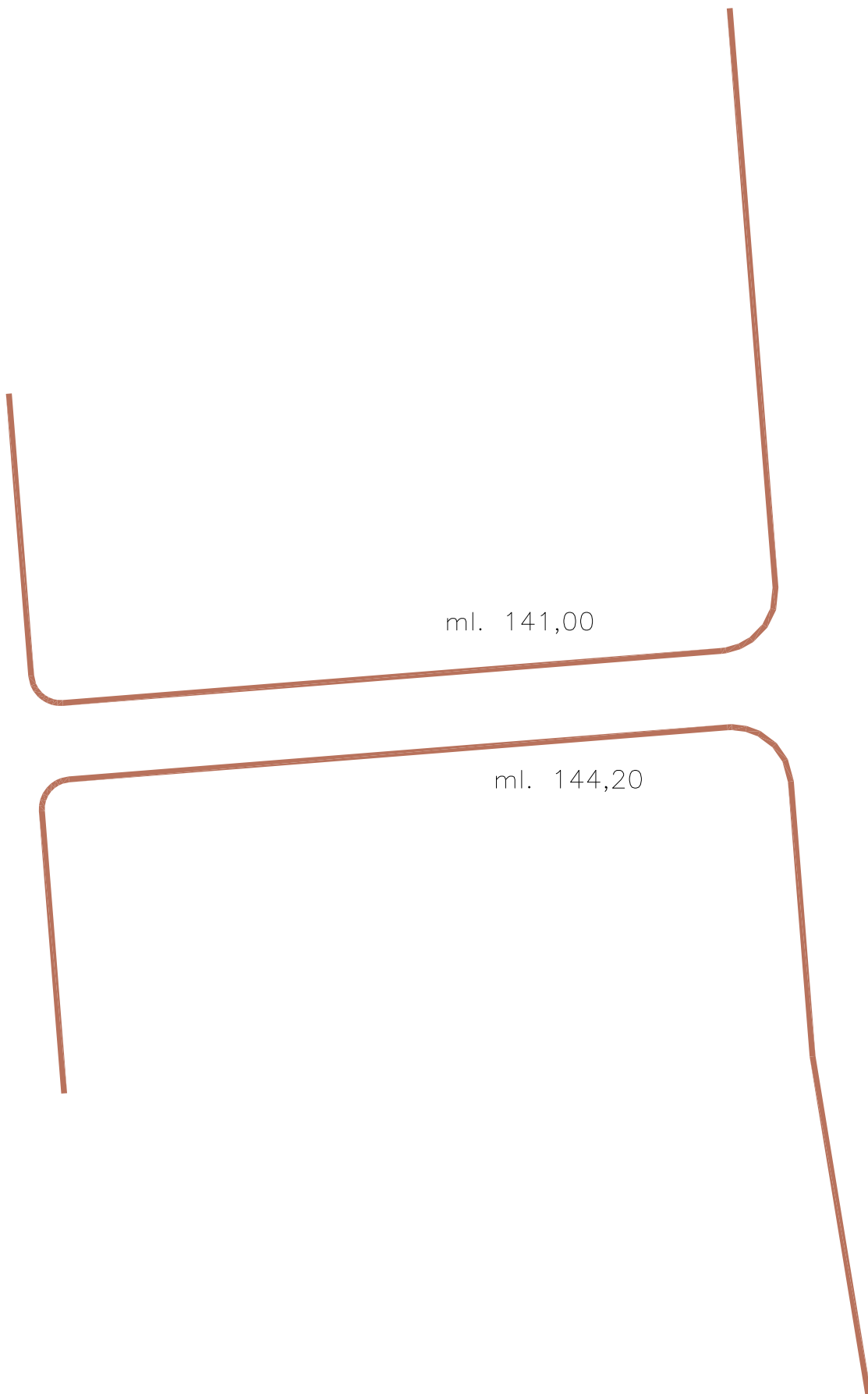

ml. 141,00

ml. 144,20

CUNETTA

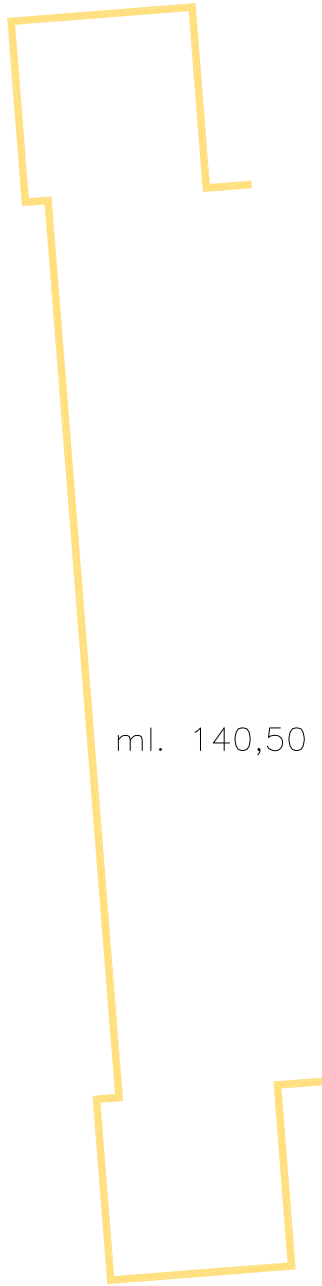

ml. 140,50

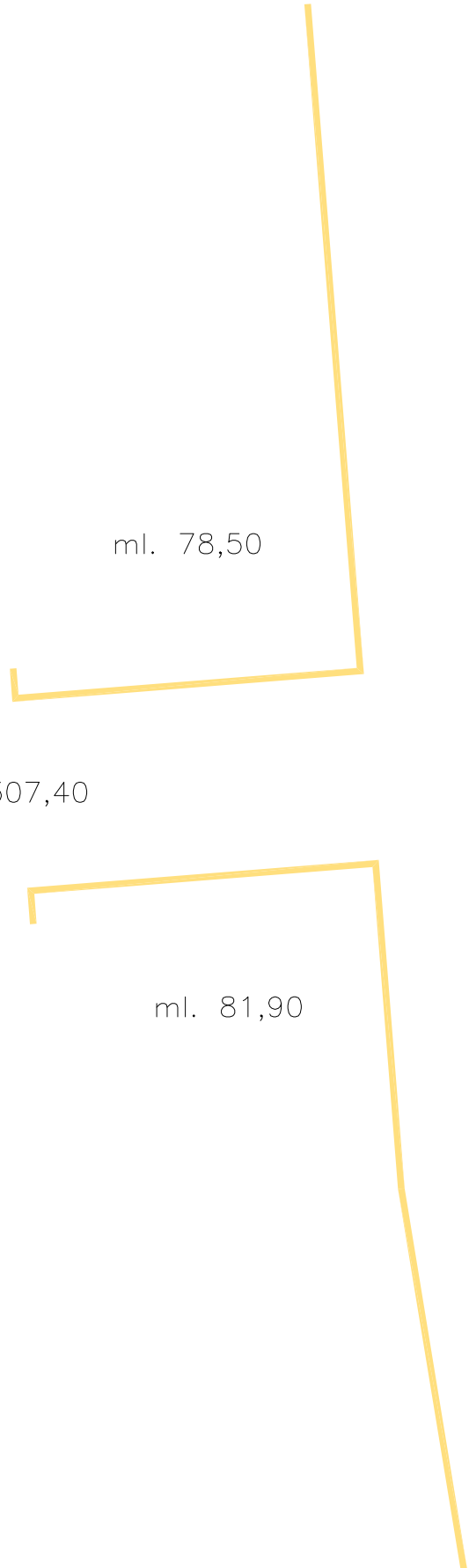

ml. 78,50

ml. 81,90

FONDAZIONI ml. 307,40

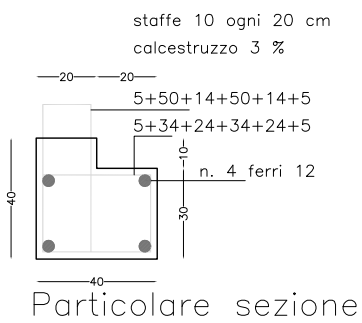

FONDAZIONI

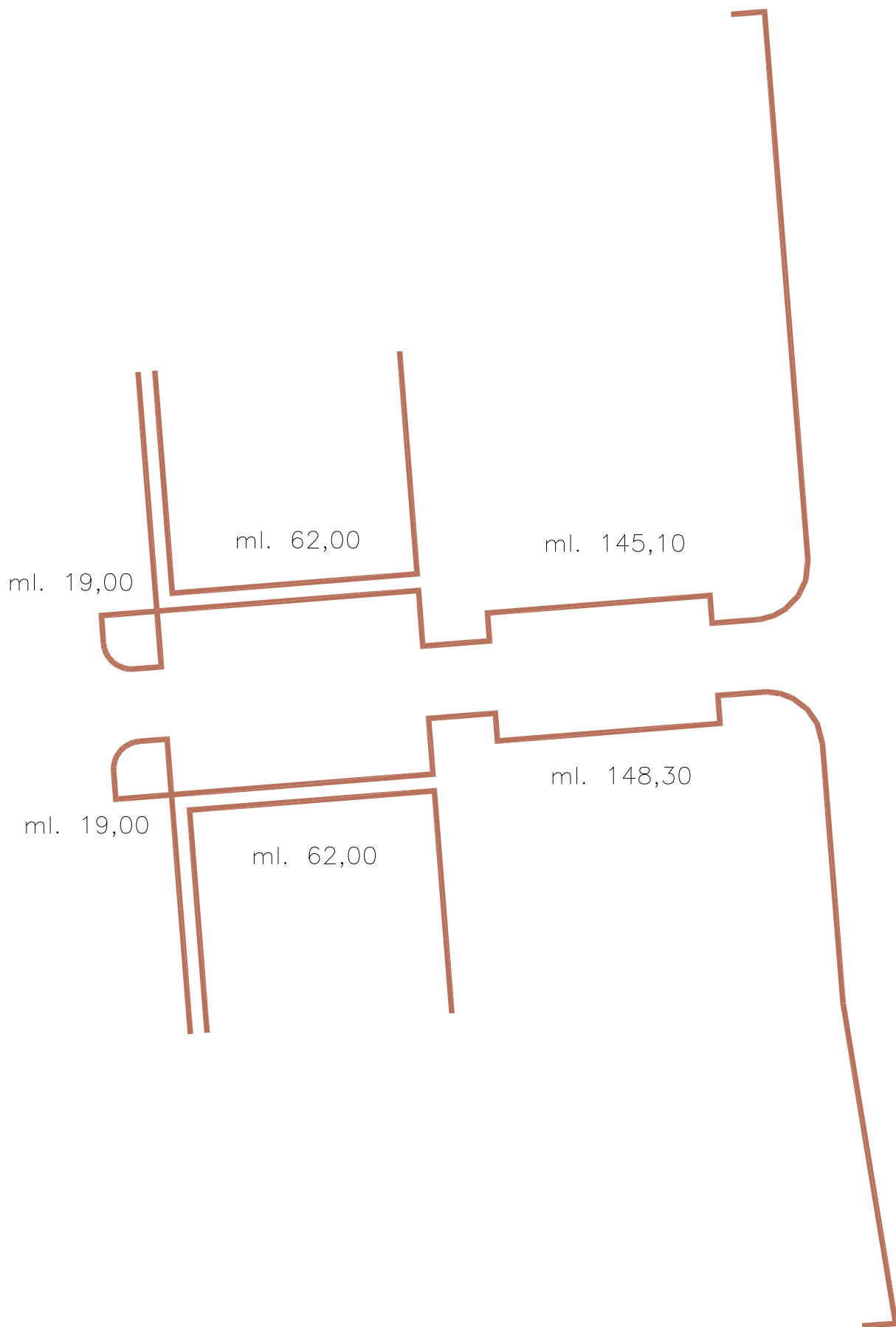

CORDONATE



ILLUMINAZIONE PUBBLICA

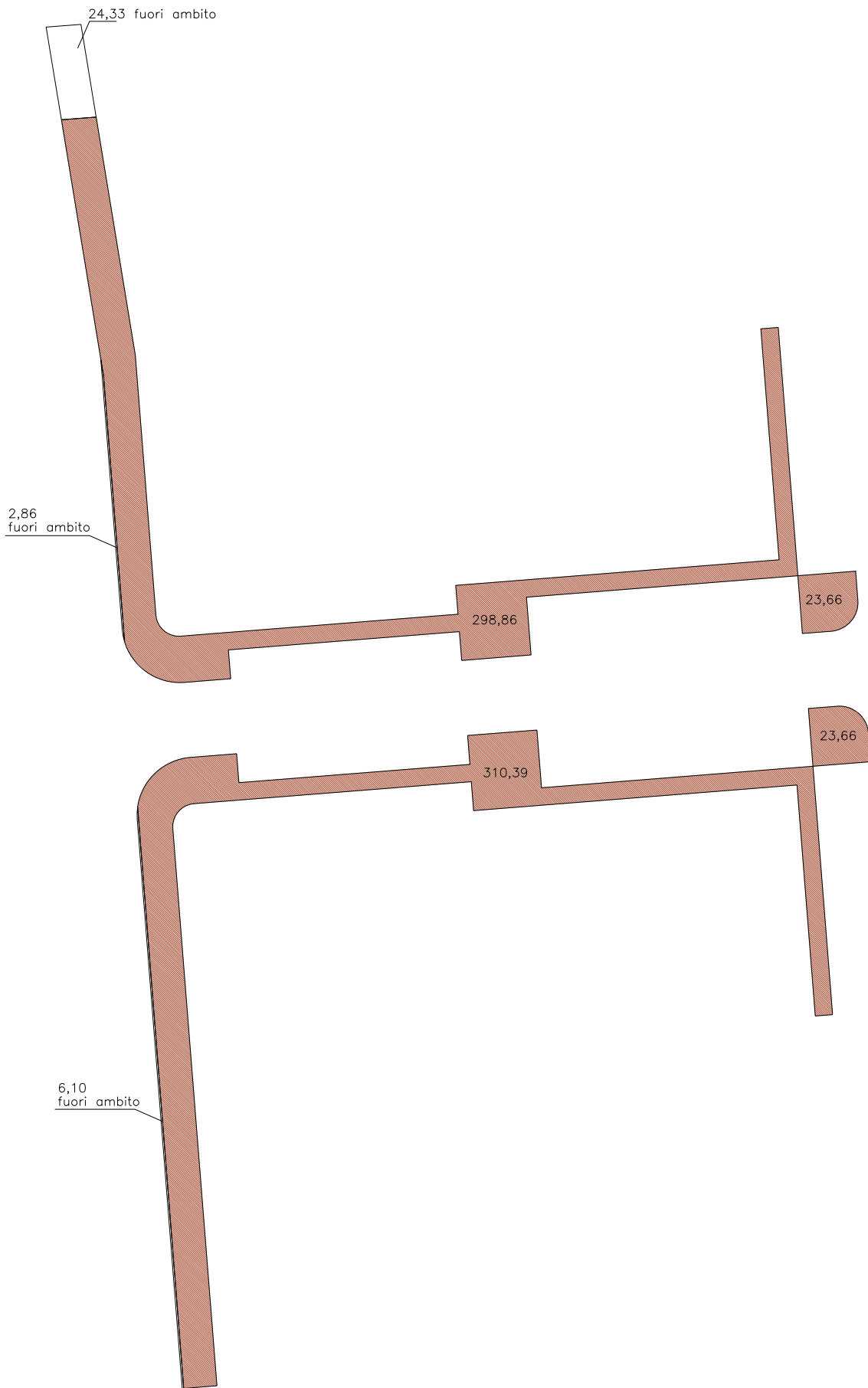

Marciapedi mq. 656,57 + 33,29

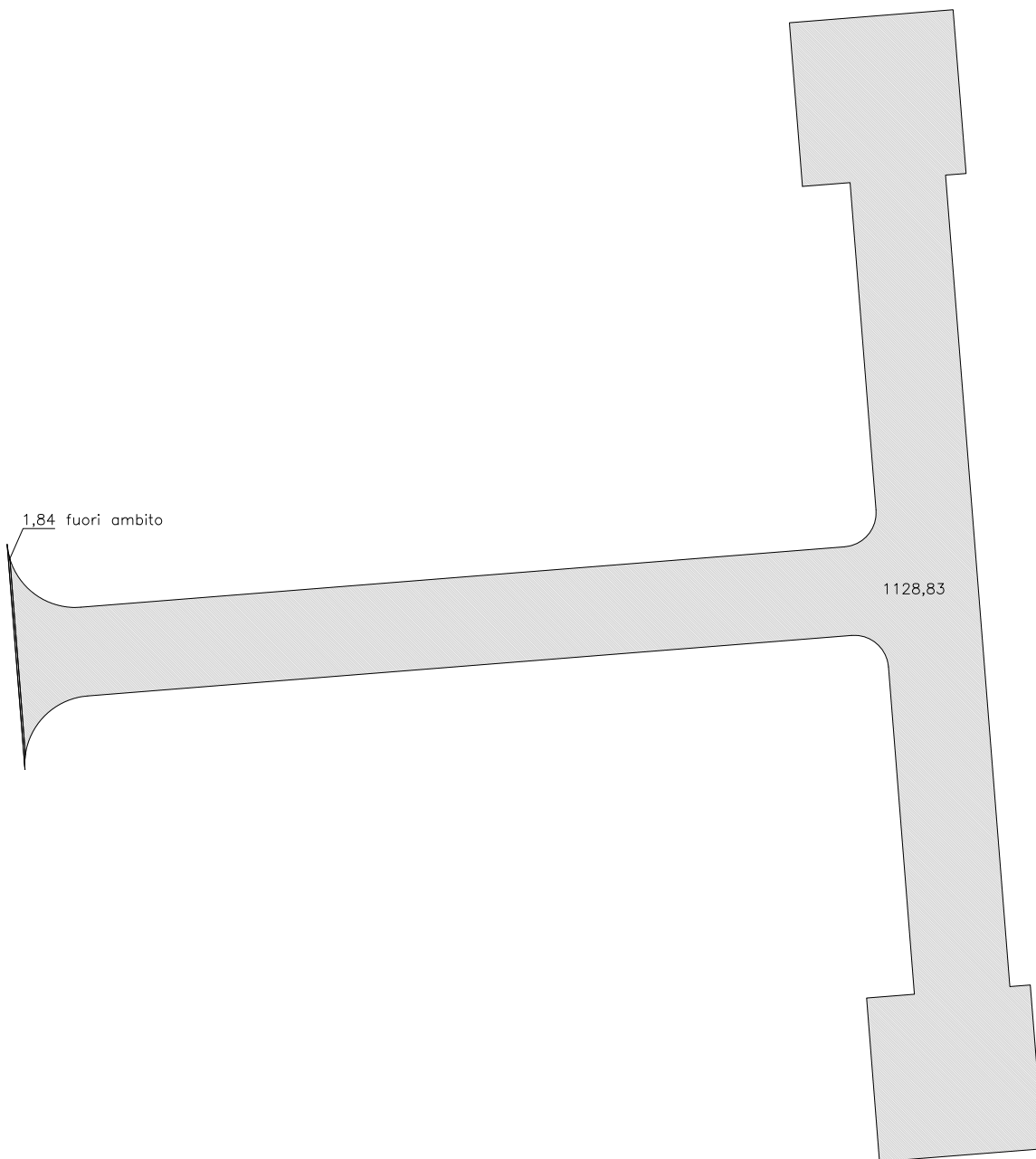

Viabilità mq. 1.128,83 + 1,84

Tratto via Olivari mq. 480 circa

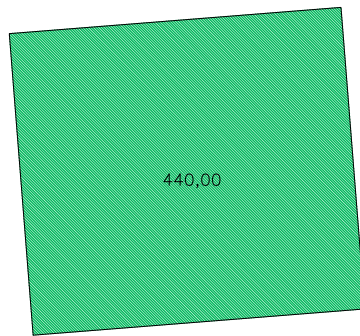

Verde mq. 880,00

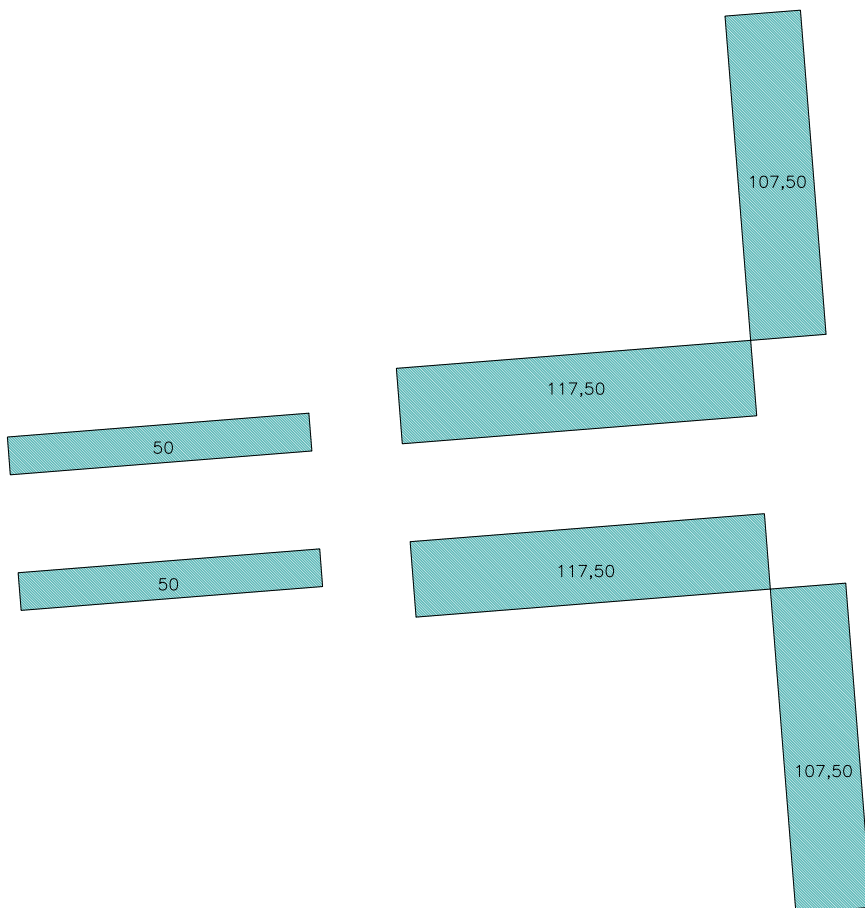

Parcheggi mq. 550,00